

# TOWN OF MAMMOTH LAKES

- MAMMOTH KNOLLS STREETS
- A. ZURS COURT
  - B. LEHT COURT
  - C. GARWISH PLACE
  - D. SESTRIERE PLACE
  - E. KITZBUHEL PLACE
  - F. COURCHEVEL COURT
  - G. CHAMONIX PLACE
  - H. DAVOS COURT
  - I. CORTINA COURT
  - J. ZERMAT COURT
  - K. VAL DISERRE PLACE
  - L. KOSIER COURT

TO  
MAMMOTH MOUNTAIN  
SKI AREA MAIN LODGE (3 MILES)  
MINARET VISTA (4 MILES)  
DEVIL'S POSTPILE (13 MILES)  
RED'S MEADOW (14 MILES)

MAMMOTH SCENIC LOOP  
TO HIGHWAY 395

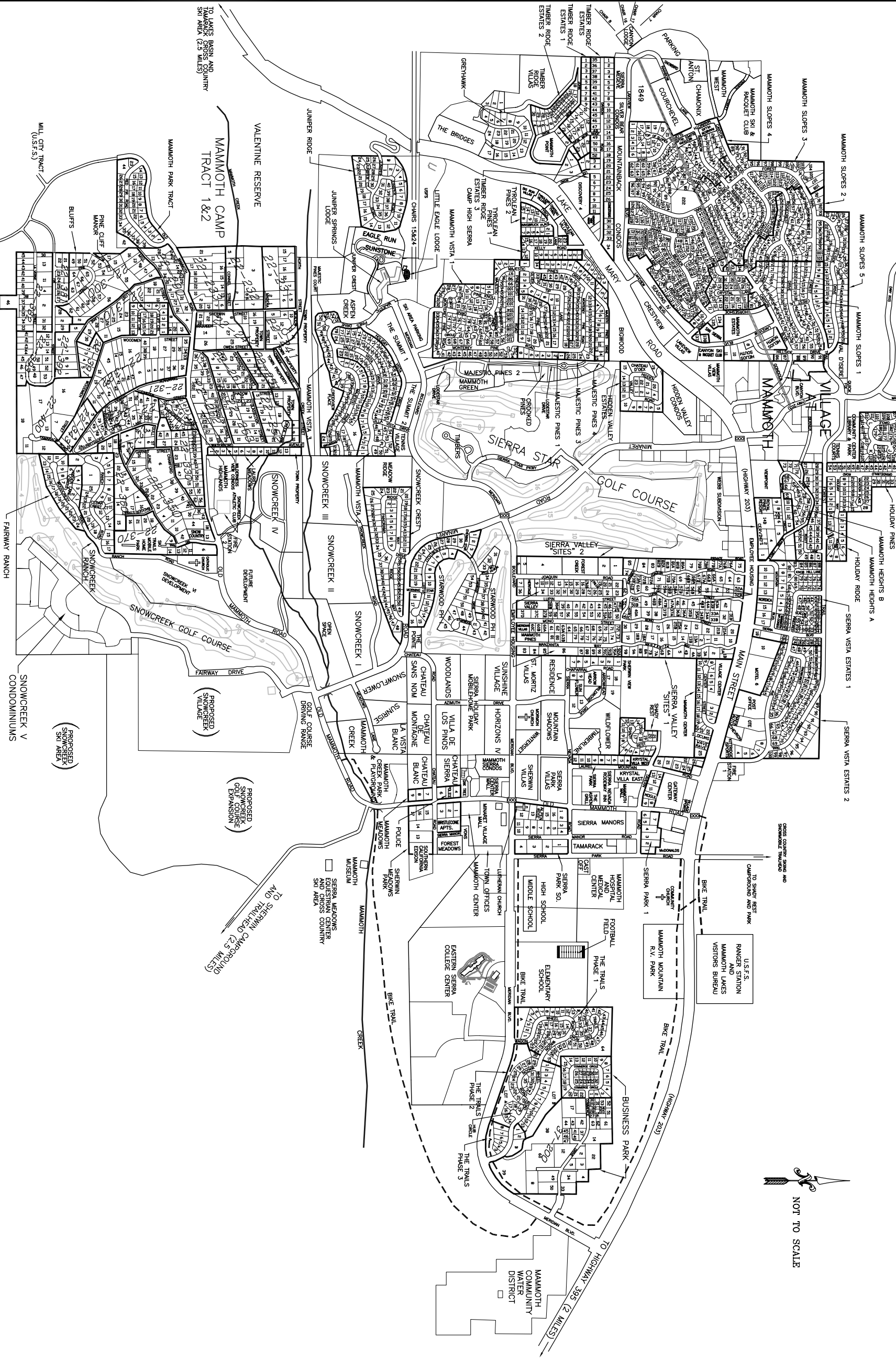
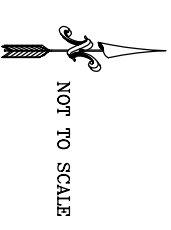

Copyright 2002, Mammoth Lakes Board of Realtors

triod/hubbers associates